

SeiMax R Coverplate EJs

SeiMax R: Roof coverplate expansion joint system. Provides multi-directional seismic or other movement. Can be powder-coated to a range of colours. The system is a ridge-cap shaped aluminium coverplate system using cbar type coupling. It is not trafficable. Secondary water seal is included. Drainage spigots are available as an accessory item. The system can be supplied in a roof-wall version.

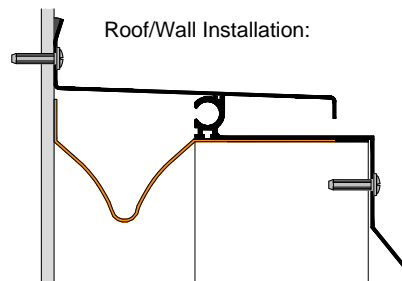
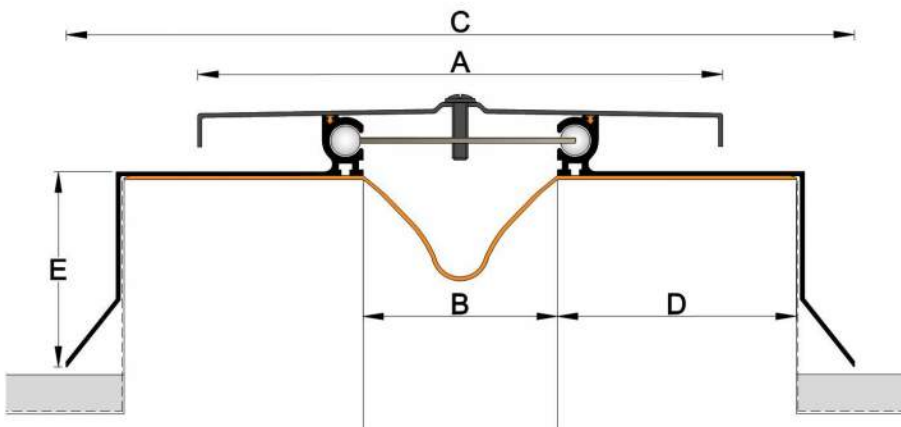
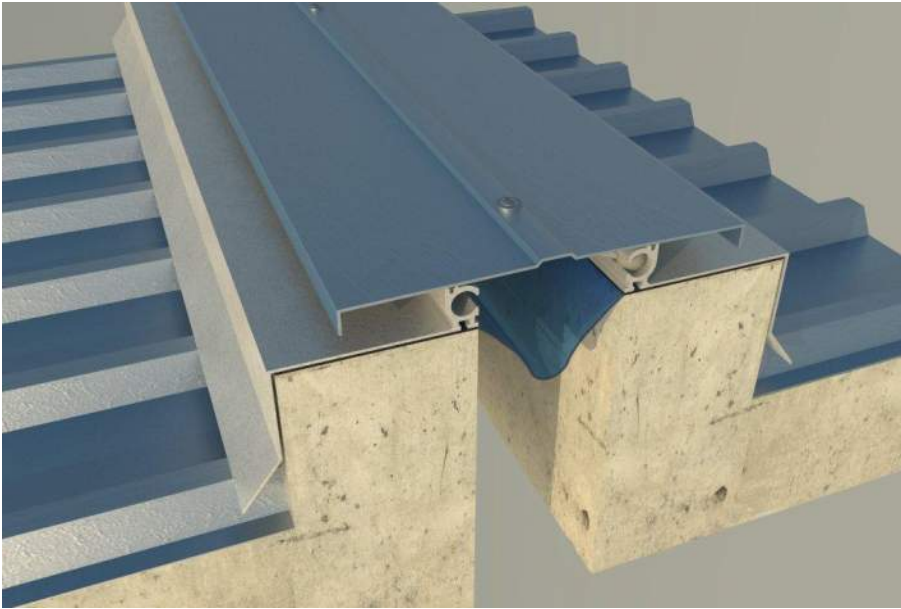

Si R

Previous Model No: SURAC



Performance

Roof seismic joint
Primary & secondary weather seal
Thermal & seismic movement

Standard Length

4.8m

Standard Finish

Anodised Aluminium

Options



Powder Coat



Fire Rating



Product	A: Coverplate		B: Gap				C: Exposed Width		
	Width	Thick	Min.	Mid.	Max.	Mvmt.	Min.	Mid.	Max.
Si170R	170	48	40	75	110	70	345	380	415
Si270R	270	48	40	125	210	170	445	530	615
Si370R	370	48	40	175	310	270	545	680	815

Block Out: 125D x 90E

Disclaimer: All design rights reserved. Design and specifications are subject to change without notice. The manufacturer does not accept liability where the material on these pages is misconceived, exploited, or lacks conformity. The intention of this information is to provide a reasonable description of products, procedures and capabilities. Rev.2